

# RoHS

Cir- cuits	Dimension (mm)	
	L1	L2
3	4.00	6.50
4	6.00	8.50
5	8.00	10.50
6	10.00	12.50
7	12.00	14.50
8	14.00	16.50
9	16.00	18.50
10	18.00	20.50
11	20.00	22.50
12	22.00	24.50
13	24.00	26.50
14	26.00	28.50
15	28.00	30.50
16	30.00	32.50
17	32.00	34.50
18	34.00	36.50
19	36.00	38.50
20	38.00	40.50
21	40.00	42.50
22	42.00	44.50
23	44.00	46.50
24	46.00	48.50
25	48.00	50.50
26	50.00	52.50
27	52.00	54.50
28	54.00	56.50
29	56.00	58.50
30	58.00	60.50
31	60.00	62.50
32	62.00	64.50
33	64.00	66.50
34	66.00	68.50
35	68.00	70.50
36	70.00	72.50
37	72.00	74.50
38	74.00	76.50
39	76.00	78.50
40	78.00	80.50

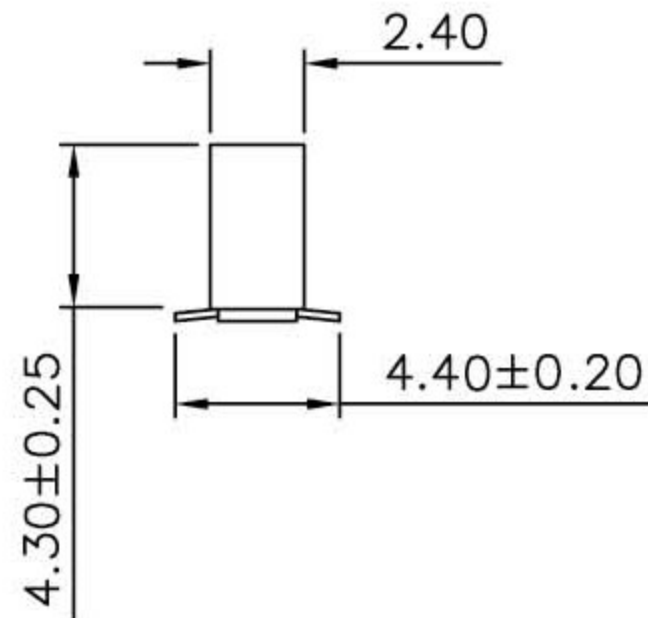
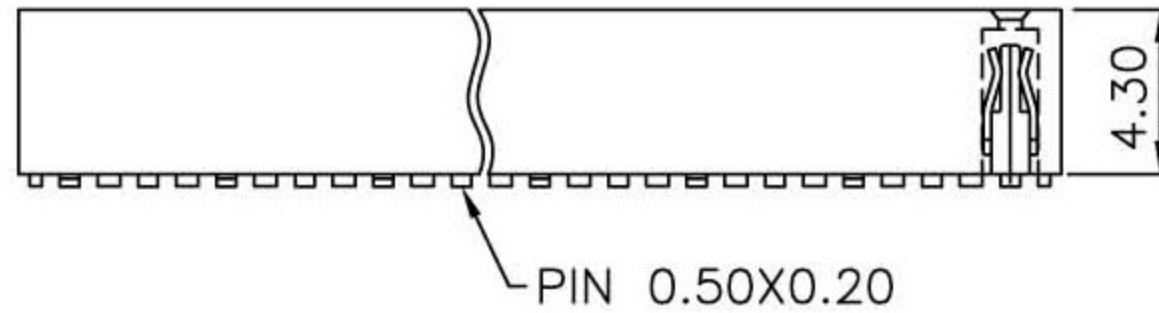
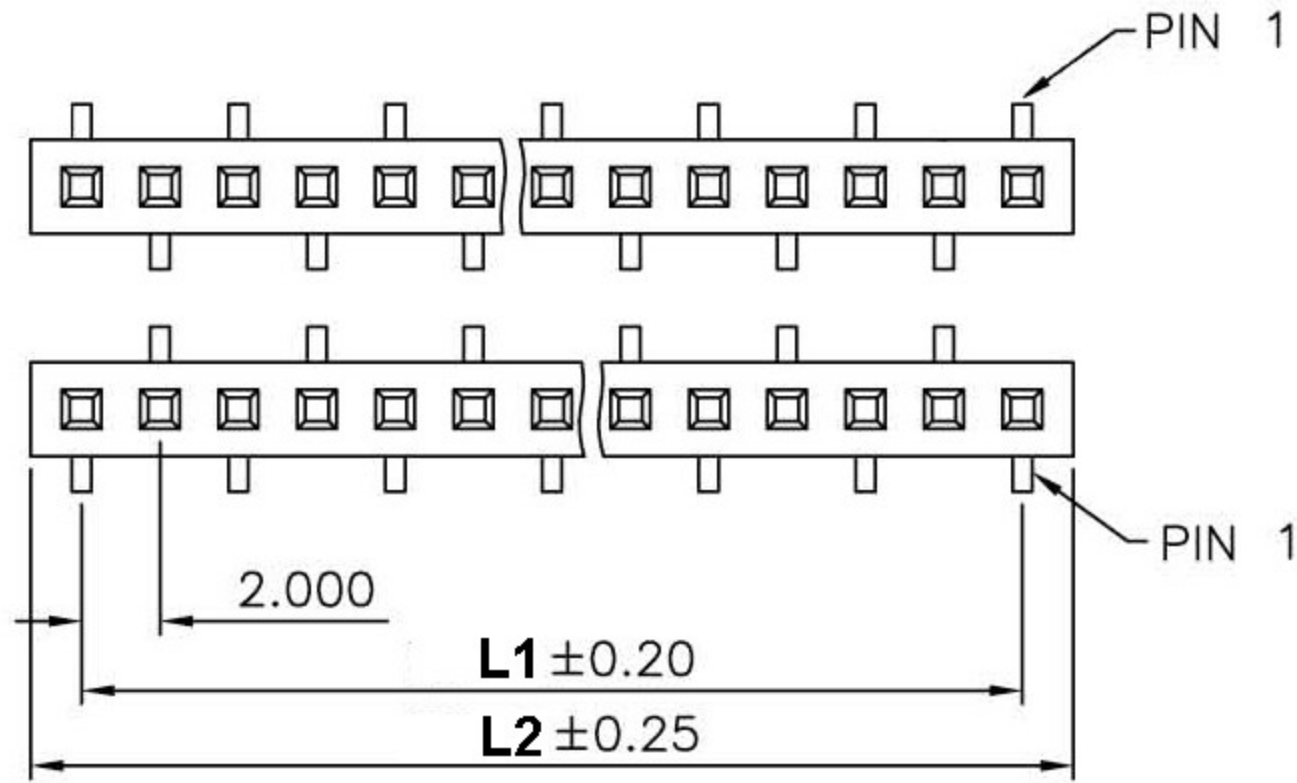

### SPECIFICATION

Current Rating: 1Amp  
 Insulator Resistance: 5000 Megohms Min.  
 Contact Resistance: 20 Milliohms Max.  
 Dielectric Withstanding: AC 500V  
 Operating Temperature:  $-40^{\circ}\text{C} \sim +105^{\circ}\text{C}$   
 Max Processing Temp:  $230^{\circ}\text{C}$  For 60 Seconds  
 $260^{\circ}\text{C}$  For 10 Seconds  
 Insulator Material: Polysphor, UL 94V-0  
 Standard: Nylon-9T  
 Contact Material: Phosphor Bronze.  
 Finish: Gold Flash All Over

RoHS Compliant

### RECOMMENDED P.C.B LAYOUT

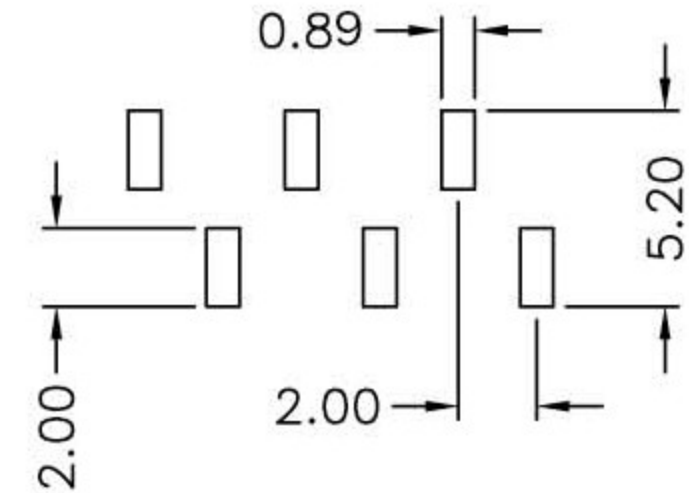

立原科技有限公司  
 Easy Show Technology Corp.

Title: Female Header 2.0mm H:4.3  
 Single Row, SMD Type

Tolerances		App.	Dabbie	Units	Part no:
Linear	Angles	Chk.	Kitty	<input checked="" type="checkbox"/> mm	
.X $\pm 0.30$	X' $\pm 5^{\circ}$	Dr.	Eddy	<input type="checkbox"/> mm	
.XX $\pm 0.20$	X' $\pm 2^{\circ}$	Date.	2007.09.12	Size A4	Dwg no:
.XXX $\pm 0.10$	.XX' $\pm 1^{\circ}$			Scale 1:1	Sheet 1/1
Projection					