

RoHS

Specification:

Current Rating : 1.0 Amp Max.
 Voltage Rating: 30V AC/DC(rms).
 Withstanding Voltage: 500V DC/1minute.
 Insulation Resistance: 100M Ω Min.
 Contact Resistance: 30m Ω Max.
 Operating Temperature: -40° C ~+85° C.

Material:

Insulator: LCP(VECTRA)or PBT+30% Glass Fiber.
 Contact: Brass Strap(C2680) T=0.20.
 Contact Plated : Gold or Tin over Nickel Plated.
 Shell: SPCC , T=0.30, Nickel Plated.
 Color: Black / White / Beige

Mechanical Characteristics:

Contact Insertion Force: 3.57 Kgf Max.
 Contact Separation Force: 1.0 Kgf Min.

Recommended P.C.B Layout(Top Side)
 (PCB BOARD TOLERANCE \pm 0.05)

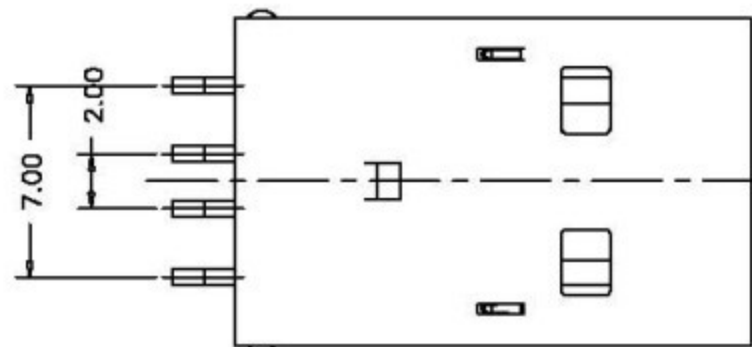
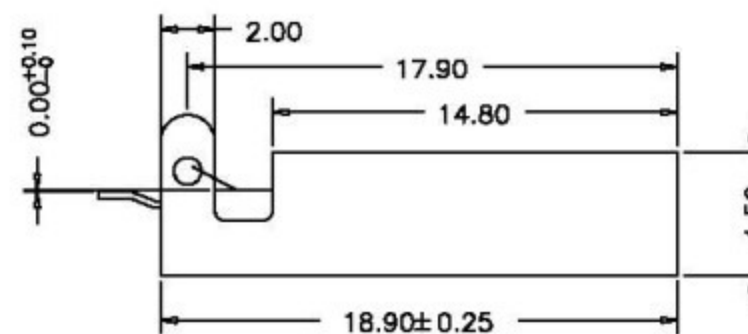
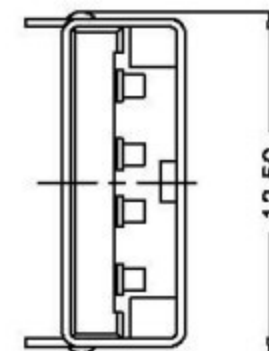
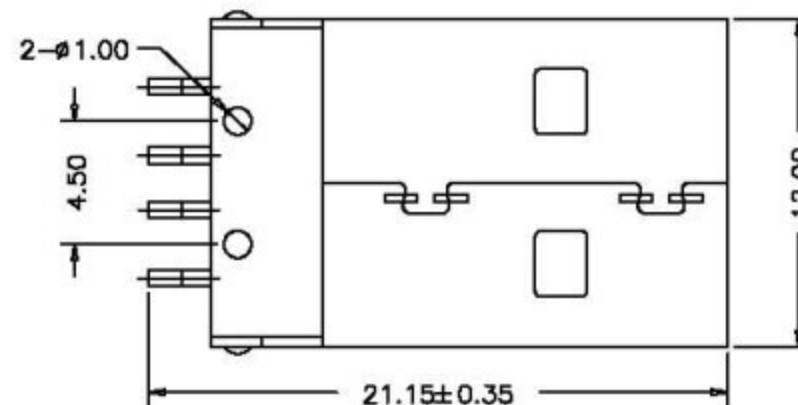
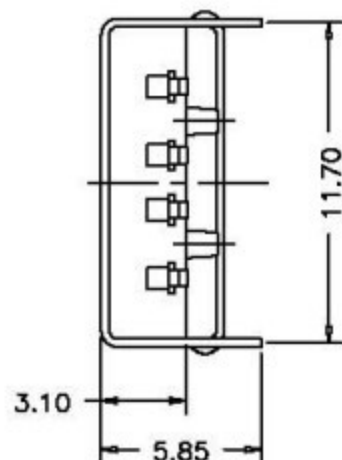
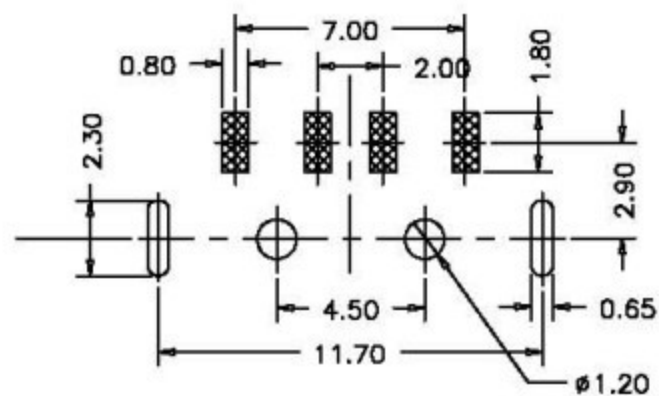

立原科技有限公司
 Easy Show Technology Corp.

Title: USB A/M SMD Type, W/Post
 Long Foot

Tolerances		App.	Dabbie	Units	Part no:
Linear	Angles	Chk.	Kitty	<input checked="" type="checkbox"/> mm <input type="checkbox"/> inch	
.X ±0.30	X' ± 5°	Dr.	Eddy	Size	Dwg no:
.XX ±0.20	X' ± 2°	Date.	2007.09.12	A4	
.XXX ±0.10	.XX' ± 1°			Scale	Sheet
Projection				1:1	1/1