

# RoHS

## MATERIAL

Insulator : 30% Glass fiber PBT  
Contact Pin : Brass

## SPECIFICATION

Current Rate : 1 AMP  
Insulation Resistance : 5000MΩMin. at DC 500V  
Contact Resistance : 20mΩMax. at DC 100mA  
Dielectric Voltage : AC 500V for one minute  
Operation Temperature : -40°C to + 105°C

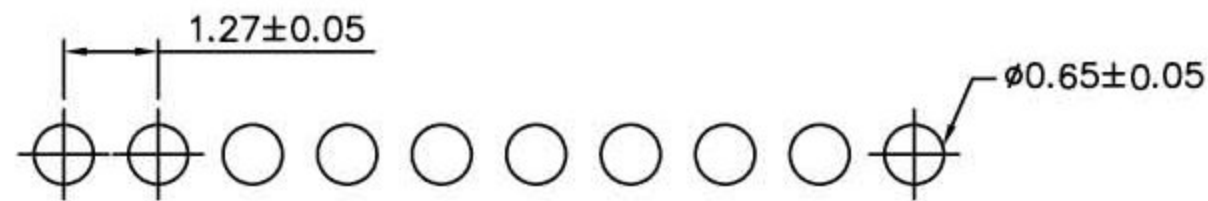
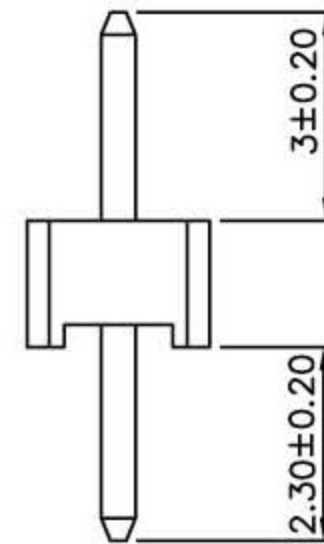
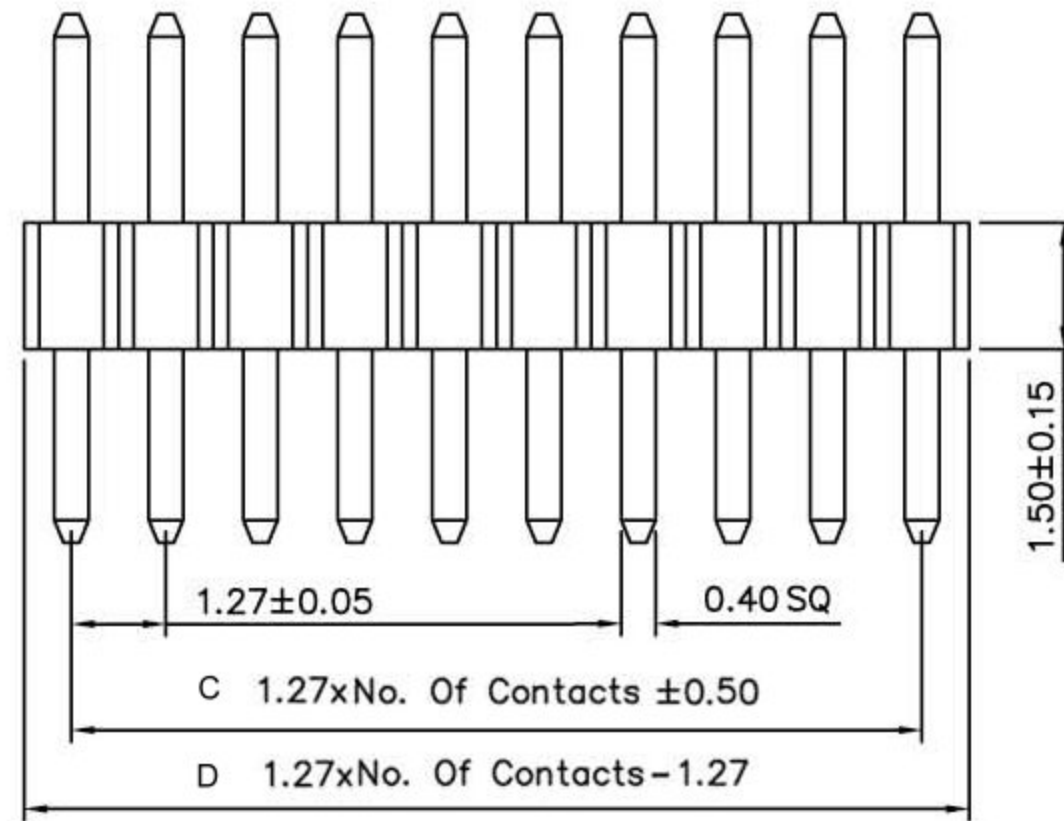

Recommended PCB Hole Layout

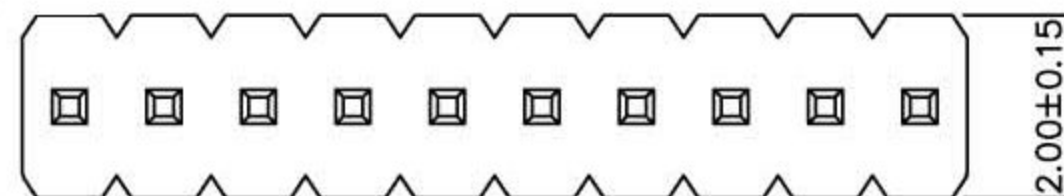

No. of Pins/Row	Dimension Information		No. of Pins/Row	Dimension Information	
	C	D		C	D
02	1.27	2.54	10	11.43	12.70
03	2.54	3.81	11	12.70	13.97
04	3.81	5.08	12	13.97	15.24
05	5.08	6.35	13	15.24	16.51
06	6.35	7.62	14	16.51	17.78
07	7.62	8.89	15	17.78	19.05
08	8.89	10.16	16	19.05	20.32
09	10.16	11.43	17	20.32	21.59

No. of Pins/Row	Dimension Information		No. of Pins/Row	Dimension Information	
	C	D		C	D
18	21.59	22.86	26	31.75	33.02
19	22.86	24.13	27	33.02	34.29
20	24.13	25.40	28	34.29	35.56
21	25.40	26.67	29	35.56	36.83
22	26.67	27.94	30	36.83	38.10
23	27.94	29.21	31	38.10	39.37
24	29.21	30.48	32	39.37	40.64
25	30.48	31.75	33	40.64	41.91

立原科技有限公司  
Easy Show Technology Corp.

Title: 1.27X1.27 Pin Header Straight Single Row

Tolerances		App.	Dabbie	Units	Part no:
Linear	Angles	Chk.	Kitty	<input checked="" type="checkbox"/> mm <input type="checkbox"/> inch	Dwg no:
.X ±0.30	X' ± 5°	Dr.	Eddy	Size A4	
.XX ±0.20	X' ± 2°	Date.	2007.09.12	Scale 1:1	Sheet 1/1
.XXX ±0.10	.XX' ± 1°				
Projection					